



**RADOMONTE**

- VENEZIA -

## Condizioni di funzionamento

Temperatura acqua calda

**max 70°**

Pressione di flusso raccomandata

**2-5 Bar**

Nel caso di pressione superiore 5 Bar è necessario installare un riduttore di pressione.

Le immagini sono puramente indicative: non rappresentano nello specifico alcun prodotto ma hanno il solo scopo di fornire adeguate e semplici istruzioni per il montaggio del prodotto.

## Operating conditions

Temperature of hot water

**max 70°**

Recommended flow pressure

**2-5 Bar**

If pressure is above 5 Bar, a pressure reducer must be installed.

Images are approximate only: they don't represent specifically any product, but they have the sole propose to provide adapt and simple instructions for product installation.



**RADOMONTE**

- VENEZIA -

Soffione Ø70 mm con braccio a parete  
Ø70 mm shower head with wall-mounted shower arm

1

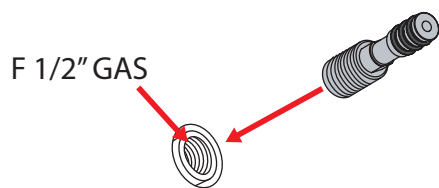

2

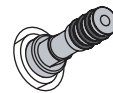

3

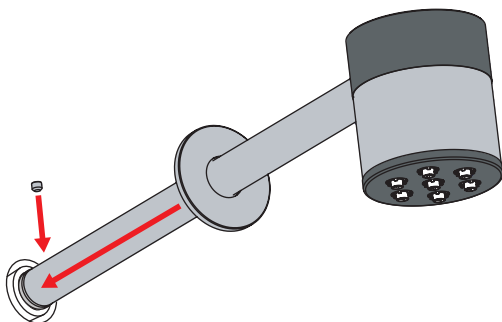

4

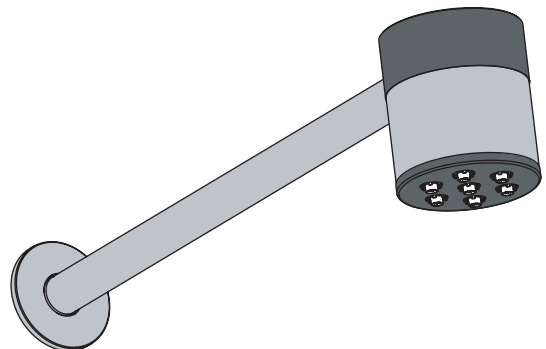

**Radomonte** by Geda

Via Maestri del Lavoro, 16/18

Z.I. Porcia Ovest - 33080 Porcia (PN) Italy

Phone +39 0434 923077

Fax +39 0434 591923

Mail: [info@radomonte.it](mailto:info@radomonte.it)

[www.radomonte.it](http://www.radomonte.it)



**RADOMONTE**

- VENEZIA -

Soffione Ø70 mm con raccordo a parete con snodo  
Ø70 mm shower head with swivel shower arm

1

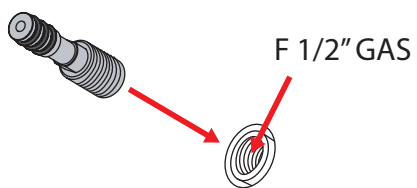

2

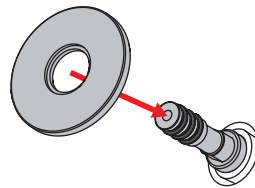

3

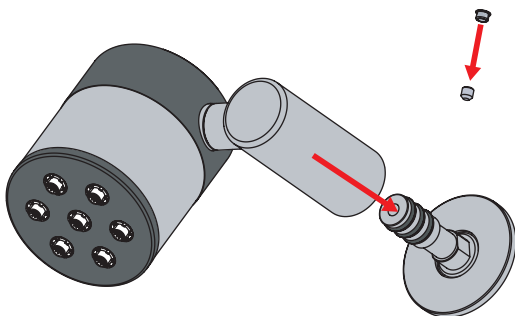

4

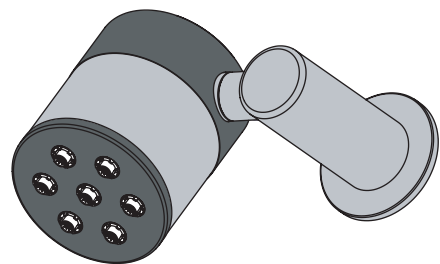

**Radomonte** by Geda

Via Maestri del Lavoro, 16/18

Z.I. Porcia Ovest - 33080 Porcia (PN) Italy

Phone +39 0434 923077

Fax +39 0434 591923

Mail: [info@radomonte.it](mailto:info@radomonte.it)

[www.radomonte.it](http://www.radomonte.it)